

# 7

# Technical Reference

## Contents

Page

7.1	Series 08 Cartridge Cavities	407-410
7.2	Series 10 Cartridge Cavities	411-415
7.3	Series 12 Cartridge Cavities	416-419
7.4	Series 16 Cartridge Cavities	420-422
7.5	Series 22 Cartridge Cavities	423
7.6	Series VH Cartridge Cavities	424-425



# Series 08 Cartridge Cavities

(Dimensions in mm)

## VC08-2

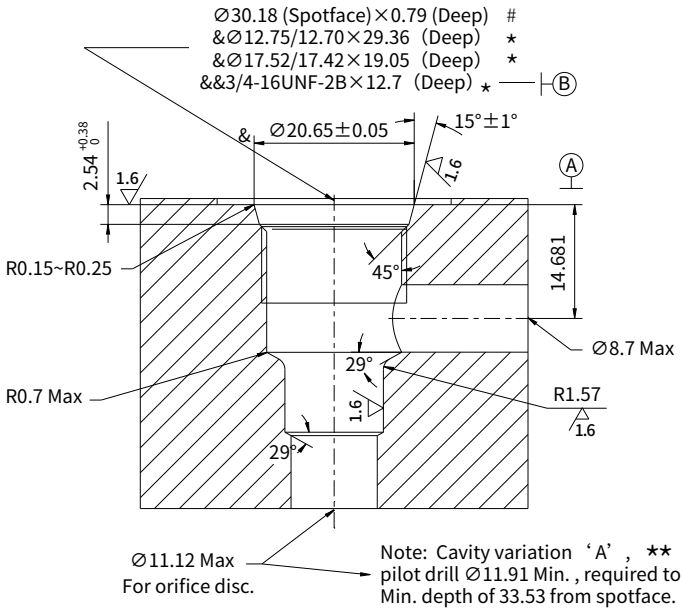

**Notes:**

The above features ( except for pilot drill and cross drills ) can be machined simultaneously using Hengli form tools. Consult factory.

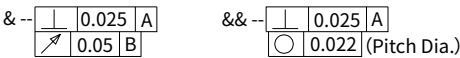

- \* -- Depths are from datum A.
- # -- Unless otherwise specified on machining drawing. Unspecified tolerances are  $\pm 0.127$ . Unspecified angular dimensions  $\pm 3^\circ$ .
- \*\* -- Features of variation 'A' are only required if noted on a specific product catalog page.

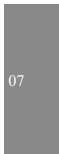

## Series 08 Cartridge Cavities

(Dimensions in mm)

## VC08-3

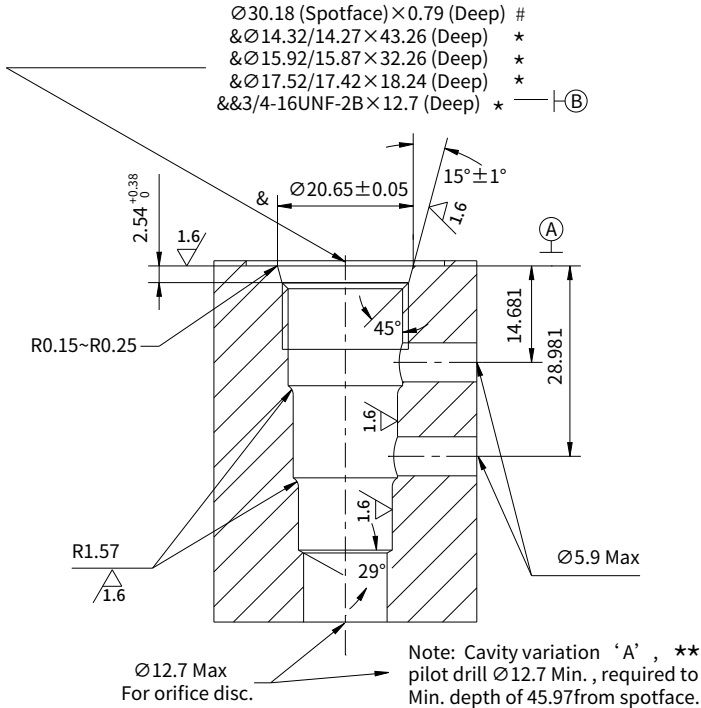

## Notes:

The above features (except for pilot drill and cross drills) can be machined simultaneously using Hengli form tools. Consult factory.

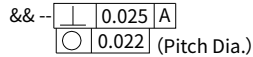
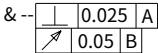

\* -- Depths are from datum A.

# -- Unless otherwise specified on machining drawing.  
 Unspecified tolerances are  $\pm 0.127$ .  
 Unspecified angular dimensions  $\pm 3^\circ$ .

\*\* -- Features of variation 'A' are only required if noted on a specific product catalog page.

# Series 08 Cartridge Cavities

(Dimensions in mm)

## VC08-4

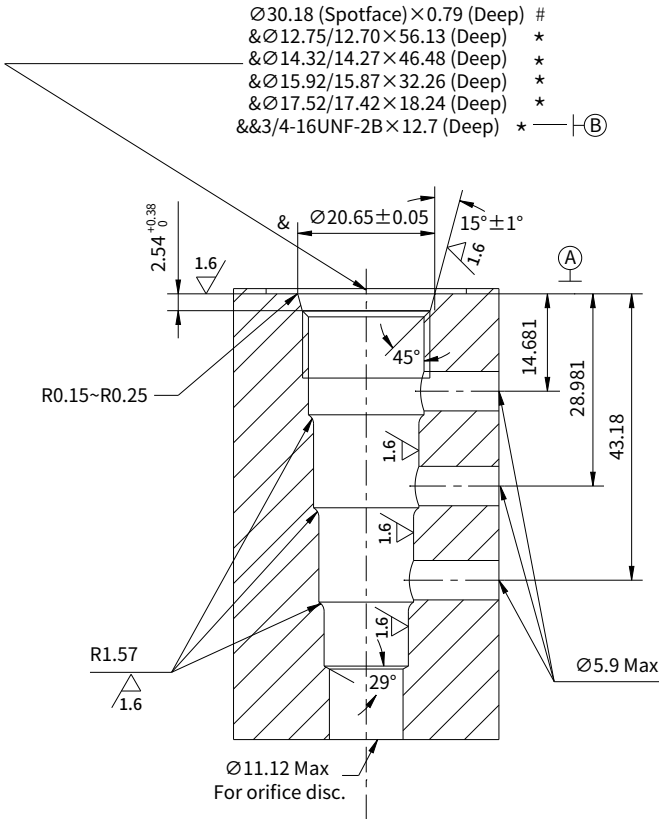

**Notes:**

The above features (except for pilot drill and cross drills) can be machined simultaneously using Hengli form tools. Consult factory.

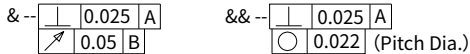

- \* -- Depths are from datum A.
- # -- Unless otherwise specified on machining drawing. Unspecified tolerances are  $\pm 0.127$ . Unspecified angular dimensions  $\pm 3^\circ$ .

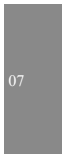

## Series 08 Cartridge Cavities

(Dimensions in mm)

## VC08-5

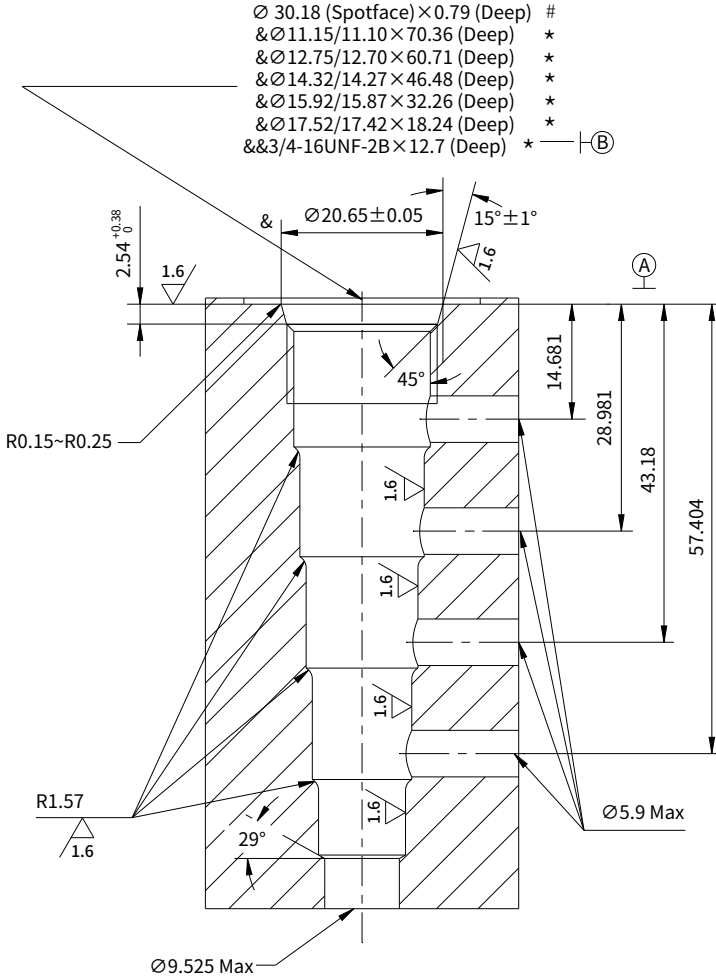

## Notes:

The above features (except for pilot drill and cross drills) can be machined simultaneously using Hengli form tools. Consult factory.

& --		0.025		A
		0.05		

&& --		0.025		A
		○		

\* -- Depths are from datum A.

# -- Unless otherwise specified on machining drawing.  
 Unspecified tolerances are ±0.127.  
 Unspecified angular dimensions ±3°.

# Series 10 Cartridge Cavities

(Dimensions in mm)

## VC10-2

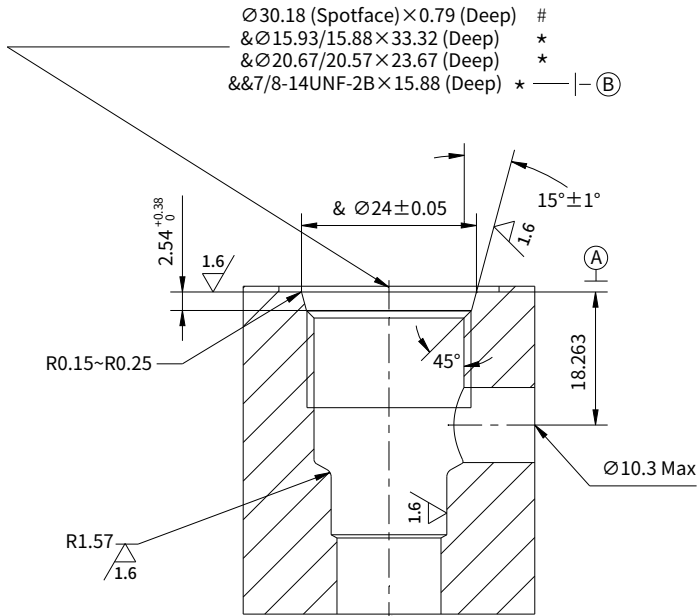

- Ø30.18 (Spotface) × 0.79 (Deep) #
- & Ø15.93/15.88 × 33.32 (Deep) \*
- & Ø20.67/20.57 × 23.67 (Deep) \*
- && 7/8-14UNF-2B × 15.88 (Deep) \* — |— (B)

Ø14.27 Max  
For orifice disc.

Note: Cavity variation 'A', \*\* pilot drill Ø14.27 Min., required to Min. depth of 38.1 from spotface.

**Notes:**

The above features ( except for pilot drill and cross drills ) can be machined simultaneously using Hengli form tools. Consult factory.

& -- 

	0.025	A
↗	0.05	B

&& -- 

	0.025	A
○	0.022	(Pitch Dia.)

- \* -- Depths are from datum A.
- # -- Unless otherwise specified on machining drawing. Unspecified tolerances are ±0.127. Unspecified angular dimensions ±3°.
- \*\* -- Features of variation 'A' are only required if noted on a specific product catalog page.

# Series 10 Cartridge Cavities

(Dimensions in mm)

## VC10-3

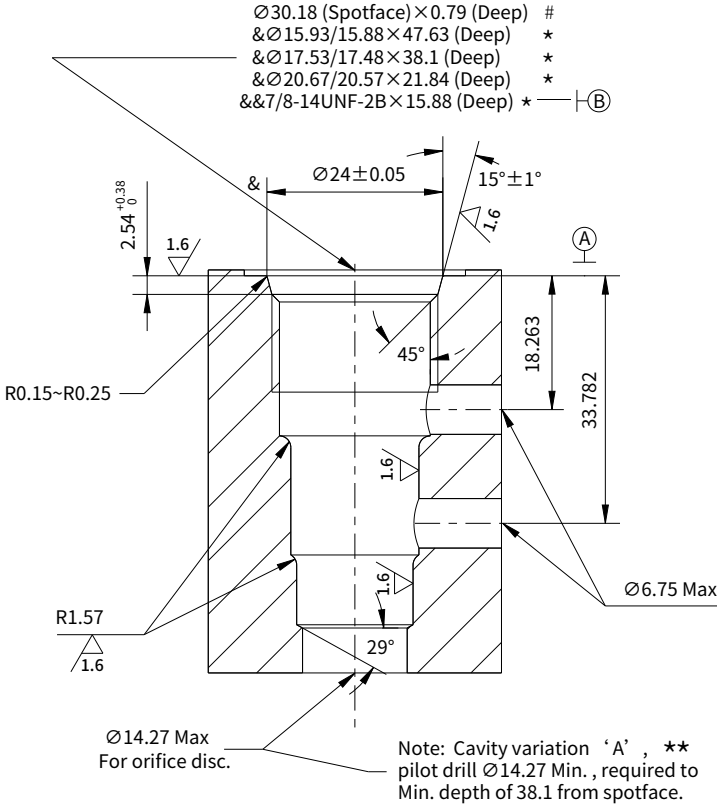

**Notes:**

The above features (except for pilot drill and cross drills) can be machined simultaneously using Hengli form tools. Consult factory.

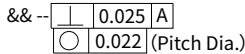
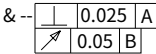

- \* -- Depths are from datum A.
- # -- Unless otherwise specified on machining drawing. Unspecified tolerances are  $\pm 0.127$ . Unspecified angular dimensions  $\pm 3^\circ$ .
- \*\* -- Features of variation 'A' are only required if noted on a specific product catalog page.



# Series 10 Cartridge Cavities

(Dimensions in mm)

## VC10-S3

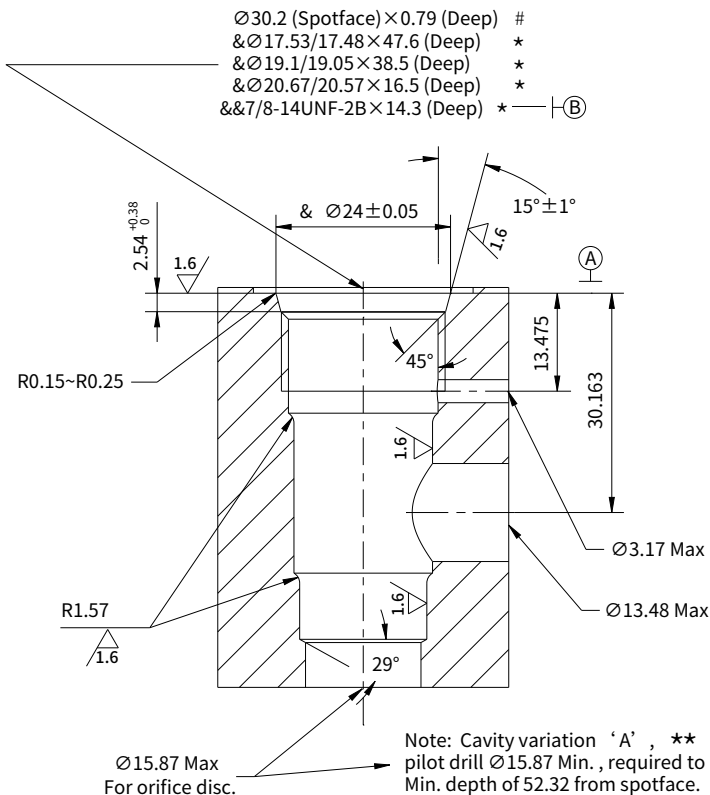

**Notes:**

The above features (except for pilot drill and cross drills) can be machined simultaneously using Hengli form tools. Consult factory.

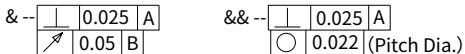

- \* -- Depths are from datum A.
- # -- Unless otherwise specified on machining drawing. Unspecified tolerances are  $\pm 0.127$ . Unspecified angular dimensions  $\pm 3^\circ$ .
- \*\* -- Features of variation 'A' are only required if noted on a specific product catalog page.



# Series 10 Cartridge Cavities

(Dimensions in mm)

## VC10-5

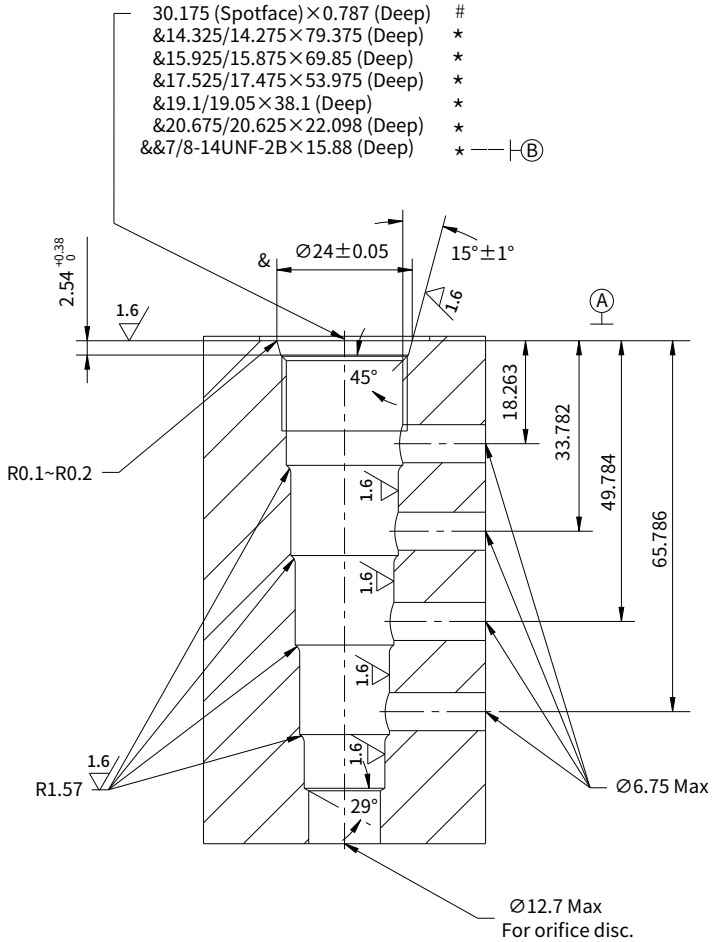

**Notes:**

The above features (except for pilot drill and cross drills) can be machined simultaneously using Hengli form tools. Consult factory.

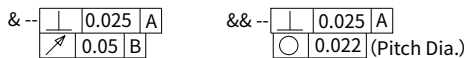

- \* -- Depths are from datum A.
- # -- Unless otherwise specified on machining drawing. Unspecified tolerances are ±0.127. Unspecified angular dimensions ±3°.

## Series 12 Cartridge Cavities

(Dimensions in mm)

## VC12-2

Ø38 (Spotface) × 0.79 (Deep) #  
 & Ø22.28/22.23 × 48.77 (Deep) \*  
 & Ø24.85/24.69 × 35.56 (Deep) \*  
 && 1-1/16-12 UN-2B × 20.6 (Deep) \* — (B)

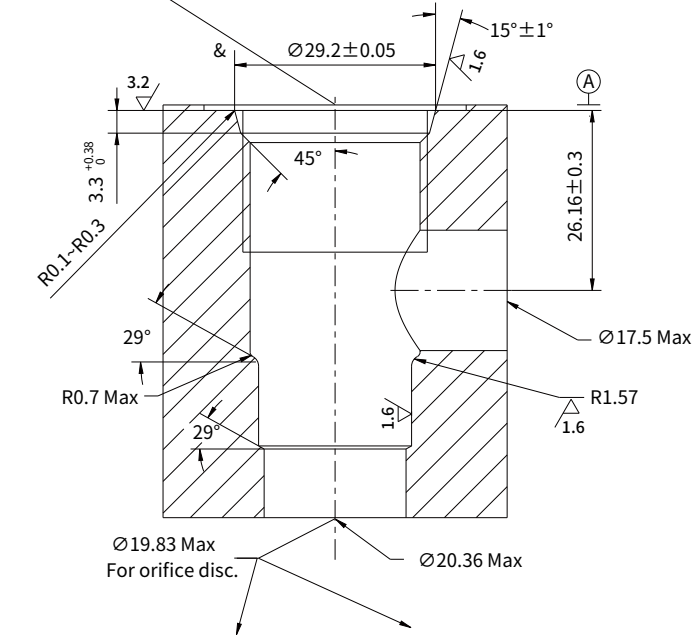

Note: Cavity variation 'A', \*\* pilot drill Ø19.05 Min., required to Min. depth of 54.4 from spotface.

Note: Cavity variation 'B', \*\* pilot drill Ø20.62 Min., required to Min. depth of 62.73 from spotface.

**Notes:**

The above features (except for pilot drill and cross drills) can be machined simultaneously using Hengli form tools. Consult factory.

	0.025	A
	0.05	B

	0.025	A
	0.022	(Pitch Dia.)

\* -- Depths are from datum A.

# -- Unless otherwise specified on machining drawing. Unspecified tolerances are  $\pm 0.127$ . Unspecified angular dimensions  $\pm 3^\circ$ .

\*\* -- Features of variation 'A' and 'B' are only required if noted on a specific product catalog page.



## Series 12 Cartridge Cavities

(Dimensions in mm)

## VC12-S3

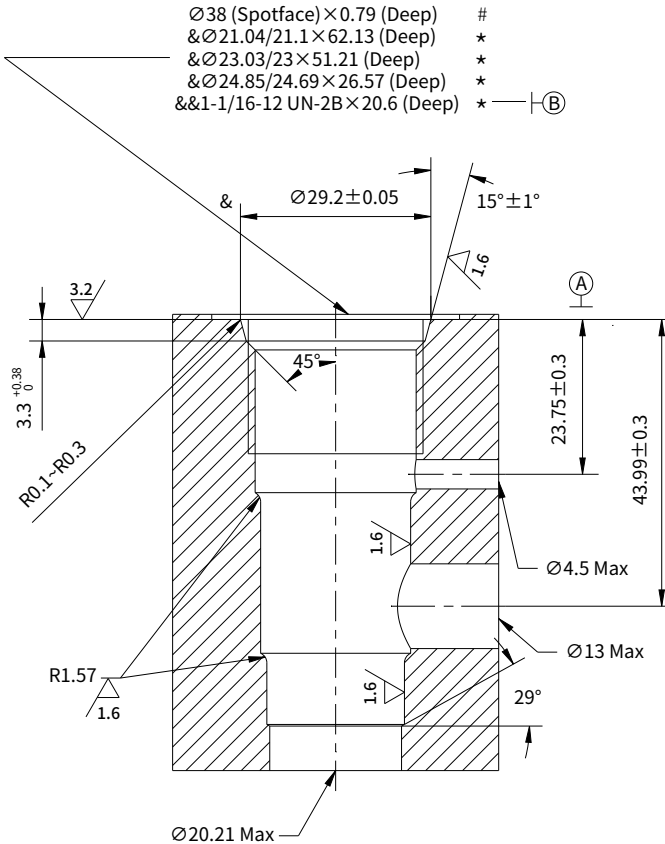
**Notes:**

The above features (except for pilot drill and cross drills) can be machined simultaneously using Hengli form tools. Consult factory.

	0.025	A
	0.05	B

	0.025	A
	0.022	(Pitch Dia.)

- \* -- Depths are from datum A.
- # -- Unless otherwise specified on machining drawing. Unspecified tolerances are  $\pm 0.127$ . Unspecified angular dimensions  $\pm 3^\circ$ .
- \*\* -- Features of variation 'A' are only required if noted on a specific product catalog page.

# Series 12 Cartridge Cavities

(Dimensions in mm)

## VC12-4

- ∅38 (Spotface) × 0.79 (Deep) #
- & ∅20.67/20.63 × 98.04 (Deep) \*
- & ∅22.28/22.24 × 84.58 (Deep) \*
- & ∅23.86/23.8 × 60.2 (Deep) \*
- & ∅24.85/24.69 × 35.56 (Deep) \*
- && 1-1/16-12 UN-2B × 20.6 (Deep) \* — (B)

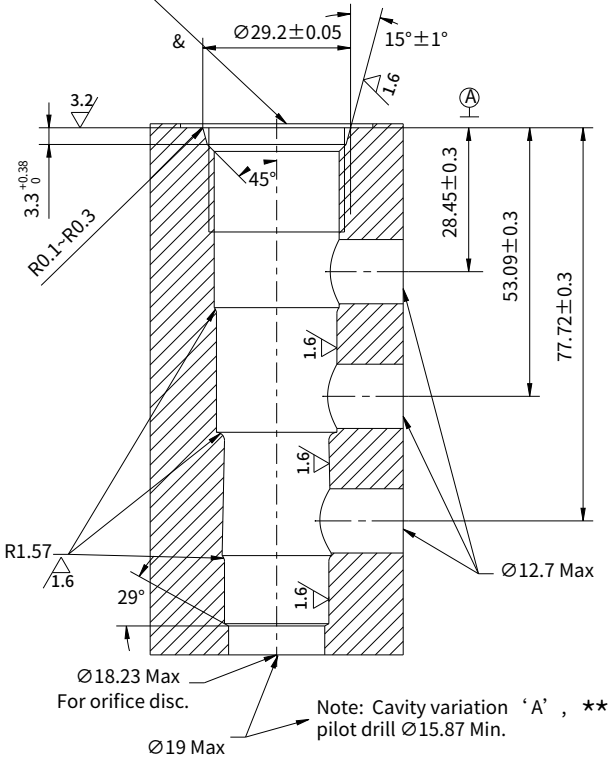

**Notes:**

The above features (except for pilot drill and cross drills) can be machined simultaneously using Hengli form tools. Consult factory.

∅		0.025	A
		0.05	B

∅		0.025	A
		0.022	(Pitch Dia.)

- \* -- Depths are from datum A.
- # -- Unless otherwise specified on machining drawing. Unspecified tolerances are ±0.127. Unspecified angular dimensions ±3°.
- \*\* -- Features of variation 'A' are only required if noted on a specific product catalog page.

## Series 16 Cartridge Cavities

(Dimensions in mm)

## VC16-2

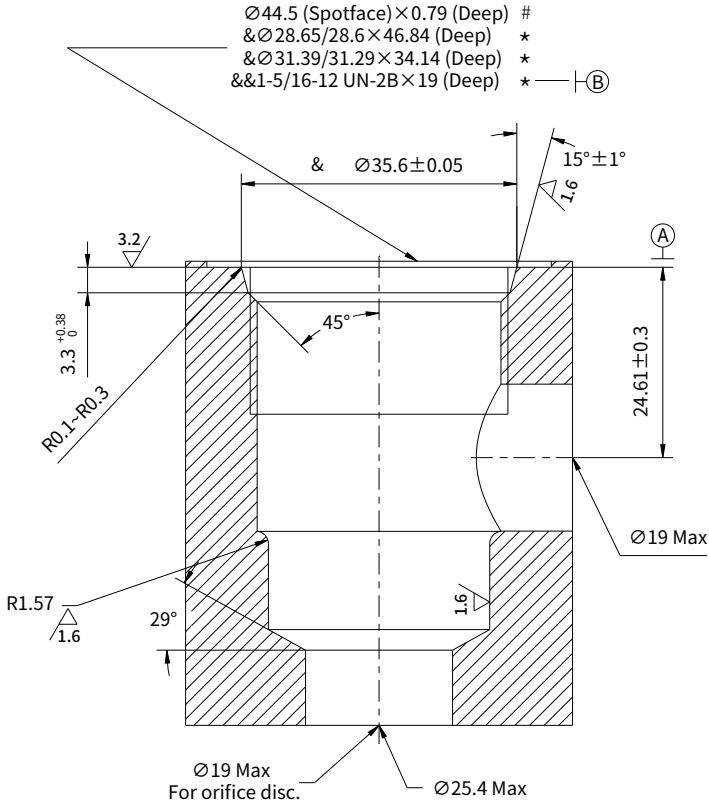
**Notes:**

The above features (except for pilot drill and cross drills) can be machined simultaneously using Hengli form tools. Consult factory.

	0.025	A
	0.05	B

	0.025	A
	0.022	(Pitch Dia.)

- \* -- Depths are from datum A.
- # -- Unless otherwise specified on machining drawing. Unspecified tolerances are  $\pm 0.127$ . Unspecified angular dimensions  $\pm 3^\circ$ .



# Series 16 Cartridge Cavities

(Dimensions in mm)

## VC16-3

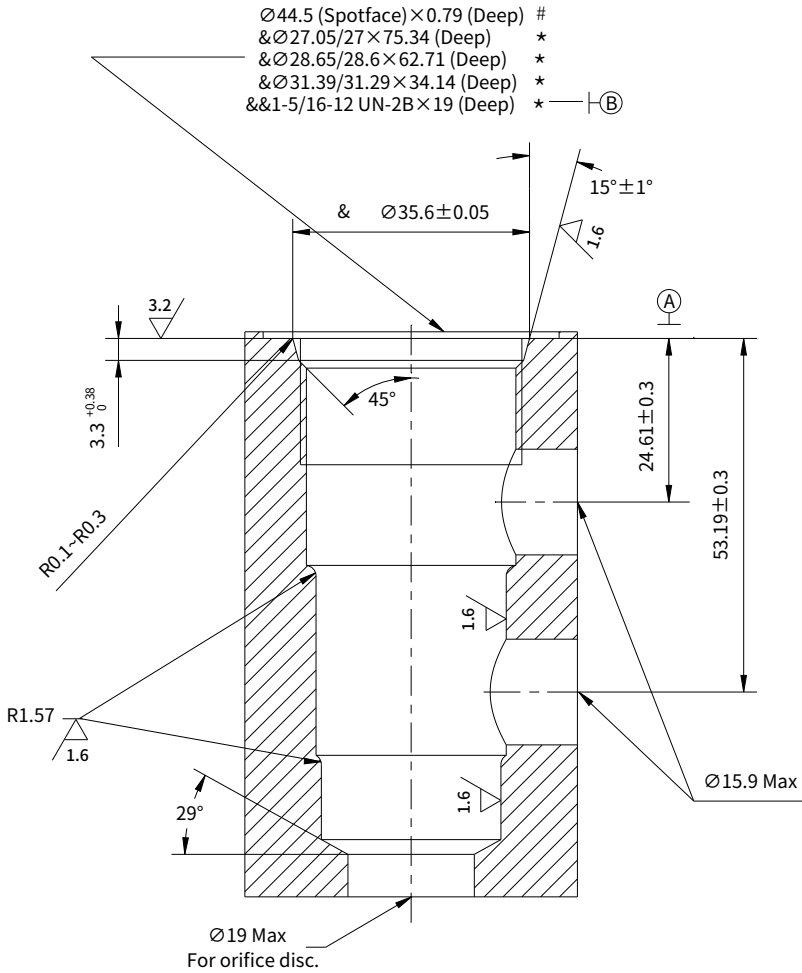

**Notes:**

The above features (except for pilot drill and cross drills) can be machined simultaneously using Hengli form tools. Consult factory.

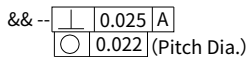
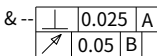

\* -- Depths are from datum A.

# -- Unless otherwise specified on machining drawing. Unspecified tolerances are  $\pm 0.127$ . Unspecified angular dimensions  $\pm 3^\circ$ .

# Series 16 Cartridge Cavities

(Dimensions in mm)

## VC16-4

- ∅44.5 (Spotface) × 0.79 (Deep) #
- & ∅25.48/25.43 × 103.99 (Deep) \*
- & ∅27.05/27 × 91.29 (Deep) \*
- & ∅28.65/28.6 × 62.71 (Deep) \*
- & ∅31.39/31.29 × 34.14 (Deep) \*
- && 1-5/16-12 UN-2B × 19 (Deep) \* --- (B)

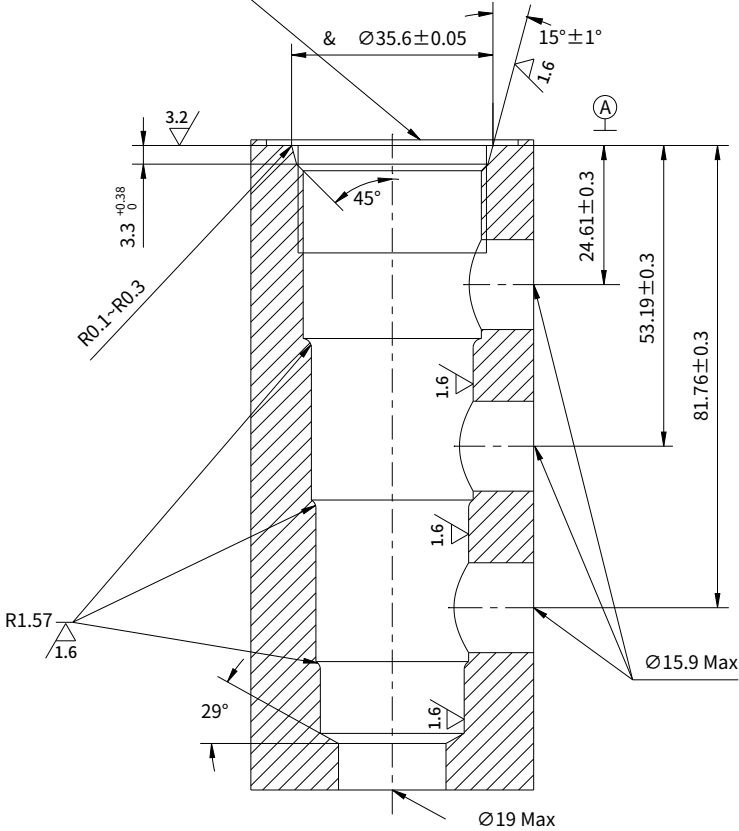

**Notes:**

The above features ( except for pilot drill and cross drills ) can be machined simultaneously using Hengli form tools. Consult factory.

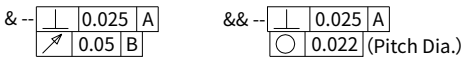

\* -- Depths are from datum A.

# -- Unless otherwise specified on machining drawing. Unspecified tolerances are ±0.127. Unspecified angular dimensions ±3°.

## Series 22 Cartridge Cavities

(Dimensions in mm)

## VC-22M-4

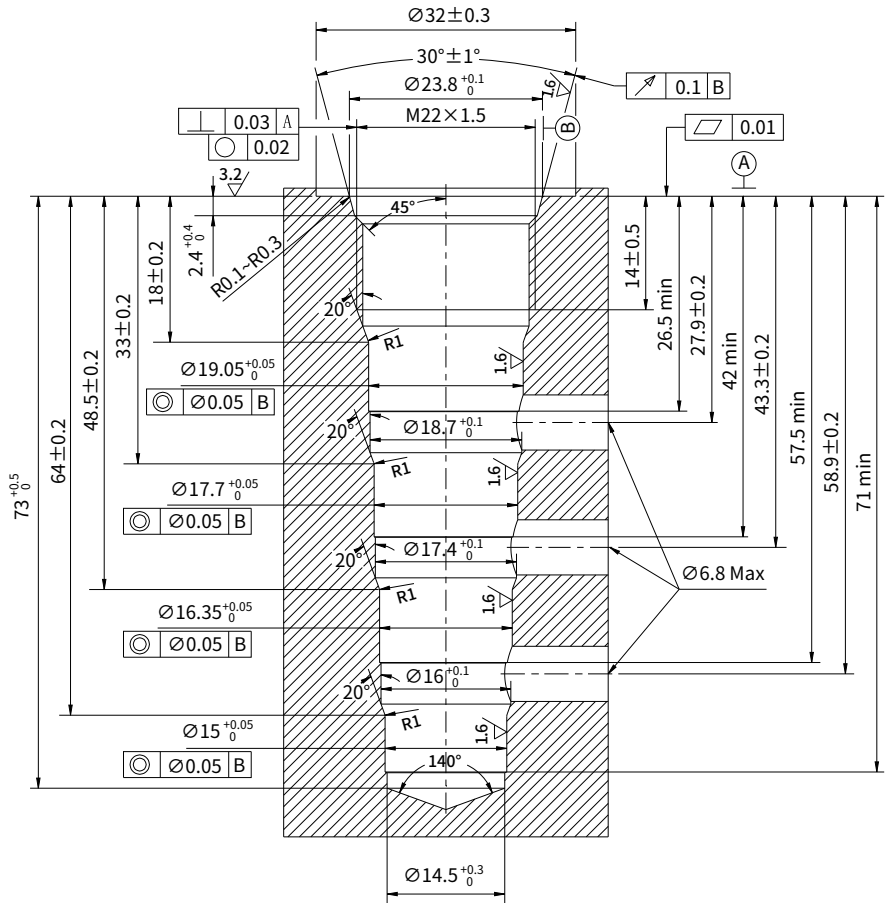
**Notes:**

The above features (except for pilot drill and cross drills) can be machined simultaneously using Hengli form tools.

Consult factory.

The perpendicularity of the valve bore related to reference A is 0.025.

## Series VH Cartridge Cavities

(Dimensions in mm)

## VH001

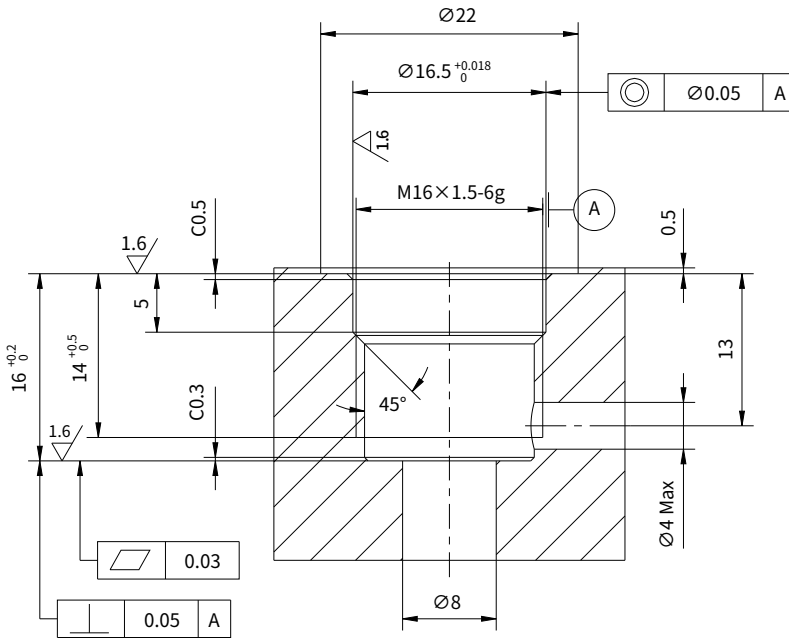
**Notes:**

The above features ( except for pilot drill and cross drills ) can be machined simultaneously using Hengli form tools. Consult factory.

